

Customer	Date	2/21/2018
Contact	Project	
Phone number	Project no.	
Email		

10HM02P11T5RVBE

104600370

Operating data

Pump type	Single head pump	Fluid	Water
No. of pumps / Reserve	1 / 0	Operating temperature t A	°C 4
Nominal flow	l/s 0	pH-value at t A	7
Nominal head	m 0	Density at t A	kg/m ³ 1000
Static head	m 0	Kin. viscosity at t A	mm ² /s 1.569
Inlet pressure	bar 0.098	Vapor pressure at t A	bar 1
Environmental temperature	°C 20	Solids	0
Available system NPSH	m 0	Altitude	m 0

Pump data

Make	Lowara	Nominal	l/s ()
Speed	1/min 2900	Flow	Max- l/s 3.9
Number of stages	2		Min- l/s
Max. casing pressure	bar		Nominal m
Max. working pressure	bar 3.1	Head	at Qmax m 14.1
Head H(Q=0)	m 31		at Qmin m 31.1
Weight	kg 16	Shaft power	kW ()
	Max. mm 73	Max. shaft power	kW 1
Impeller R	designed mm 73	Efficiency	%
	Min. mm 73	NPSH 3%	m

Pump Materials

ADAPTER	Aluminium
DIFFUSER	Stainless steel
Fill / drain plugs	Stainless steel
Head	Stainless steel
IMPELLER	Technopolymer Noryl
Outer sleeve	Stainless steel
SEAL HOUSING	Stainless steel
SHAFT	Stainless steel
Tie rods	Stainless steel
WEAR RING	Technopolymer

Ring with foot Aluminium

Shaft Seal

Mechanical Seal	Roten
HM - uniten	
Rotating Assembly	V-Ceramic
Fixed Assembly	B-Resin impregnated carbon
Elastomers	E - EPDM
Springs	G-AISI 316
Other Components	G-AISI 316

Motor data

Manufacturer	Lowara	Electric voltage	400 V	Speed	2900 1/min	Insulation class	F
Specific design	IE3 Three phase surface motor - e-HM			Frame size	56	Colour	RAL 5010
Type	SM80HM../311 E3	Electric current	2.39 A	Weight	0 kg		
Rated power	1.1 kW	Degree of protection	IP 55				

Remarks:

Customer	Date	2/21/2018
Contact	Project	
Phone number	Project no.	
Email		

10HM02P11T5RVBE

104600370

Hydraulic Data

Operating Data Specification		Hydraulic data (duty point)	Impeller design	
Flow	0 l/s	Flow	Impeller R	73 mm
Head	0 m	Head	Frequency	50 Hz
Static head	0 m		Speed	2900 1/min

Power datas refered to:

Water [100%] ; 4°C; 1000kg/m³; 1.57mm²/s

Performance according to ISO 9906:2012 – Grade 3B

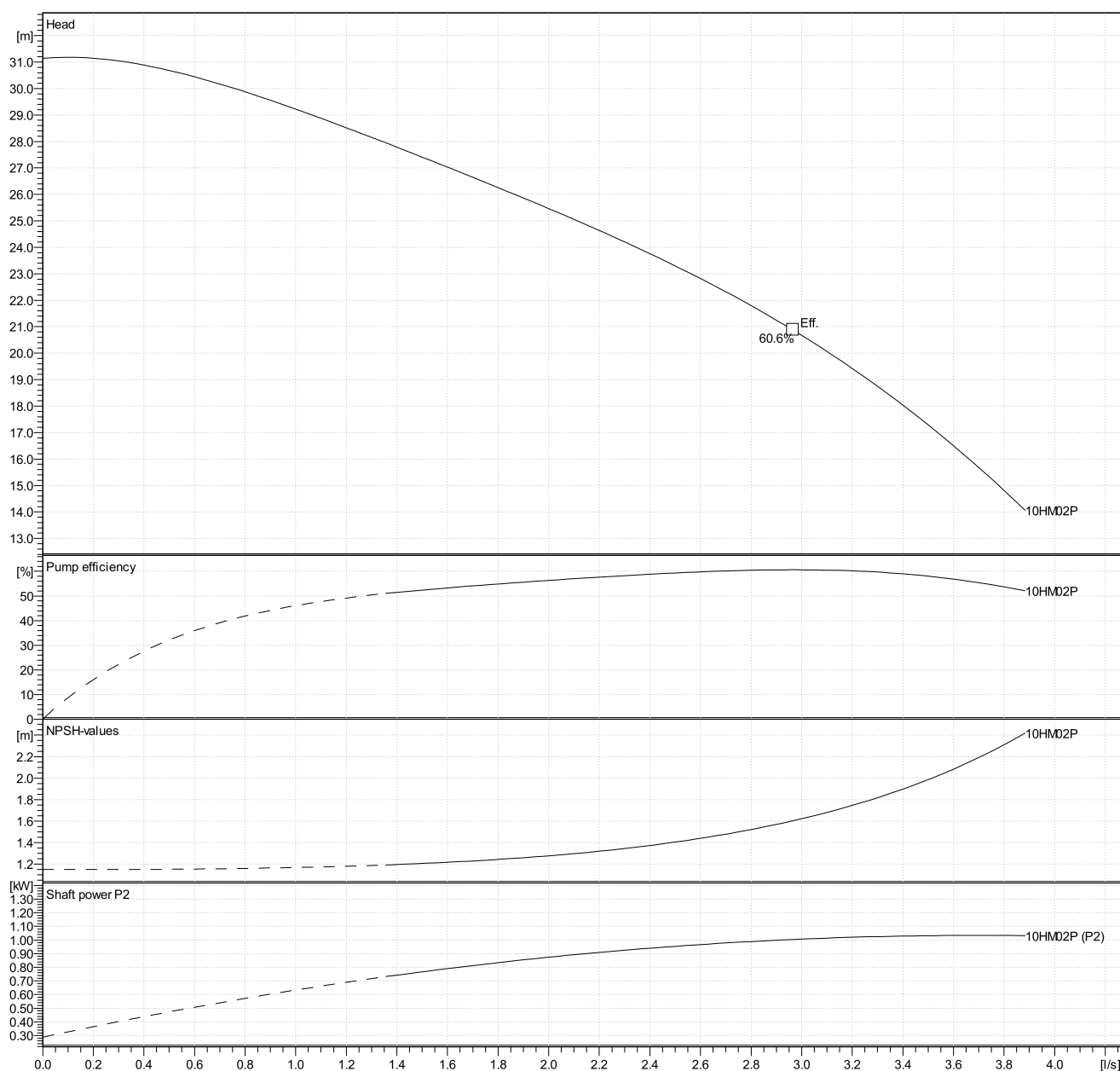

Customer	Date
Contact	Project
Phone number	Project no.
Email	

10HM02P11T5RVBE
104600370

Drawing

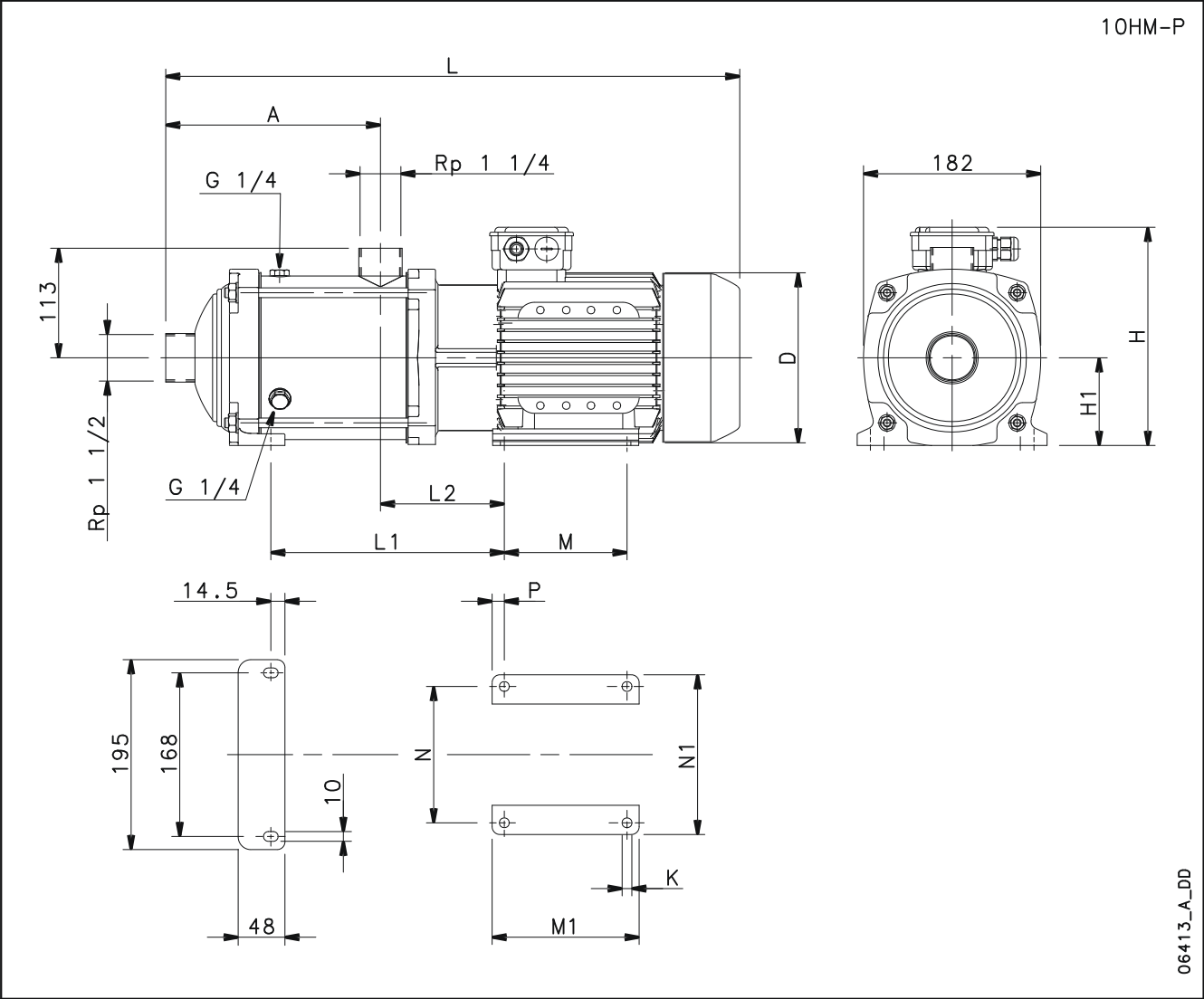

Dimensions mm

A	125	M1	125			Weight
D	155	N	125			16 kg
H	219	N1	155			
H1	90	P	12.5			
K	10	PN	10			
L	443					
L1	122					
L2	105					
M	100					

10HM02P11T5RVBE 104600370

Total lifetime	15	Inflation rate (rate of price increases)	2 %
Annual operating time	5600	Interest rate (for investment)	3 %
Energy cost per kWh	0.00 USD		
Power input P1			

Total costs

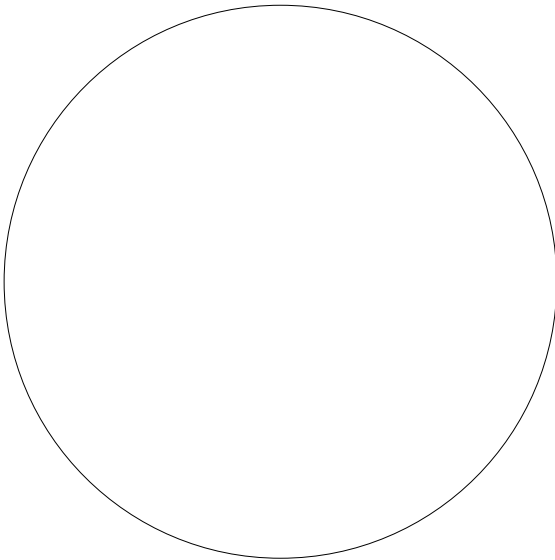

USD

0%	0.00 USD	Energy
0%	0.00 USD	Investment costs
0%	0.00 USD	Installation & commissioning
0%	0.00 USD	Operating cost
0%	0.00 USD	Maintenance & repair
0%	0.00 USD	Downtime
0%	0.00 USD	Environmental
0%	0.00 USD	Decommissioning

First year costs

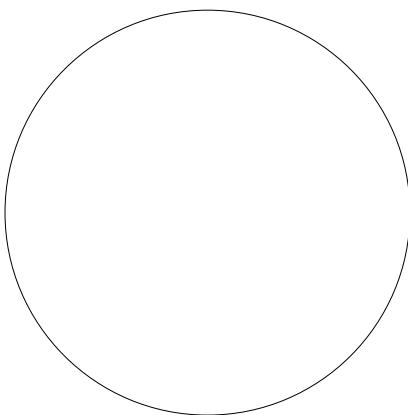

USD

0%	0.00 USD	Energy (1st year)
0%	0.00 USD	Investment costs (1st year)
0%	0.00 USD	Installation & commissioning (1st year)
0%	0.00 USD	Operating cost (1st year)
0%	0.00 USD	Maintenance & repair (1st year)
0%	0.00 USD	Downtime (1st year)
0%	0.00 USD	Environmental (1st year)
0%	0.00 USD	Decommissioning (1st year)